

INSTALLATION GUIDE - WM8016

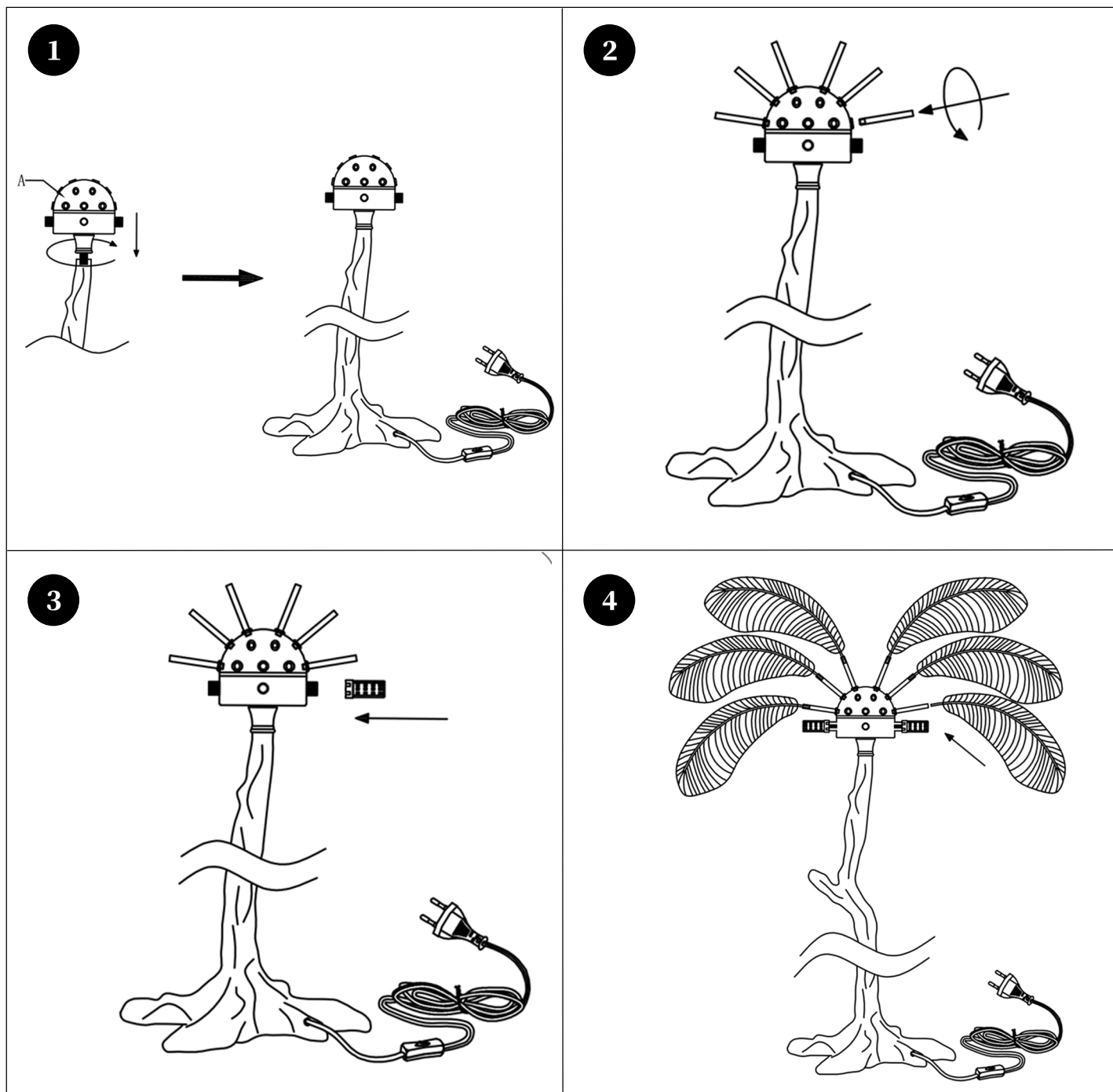

- 1. Screw A clockwise into the main body of the lamp to tighten it tightly.**
- 2. Screw the B tube clockwise into the lamp.**
- 3. The G4 light source is inserted into the lamp head, and the test is bright.**
- 4. The feather is inserted in the metal iron pipe and tested Light it on, and install it completely.**