

Warning:
This product must be installed by personnel who are familiar with its structure and related hazards, in accordance with the installation specifications. This product is suitable for indoor installation.

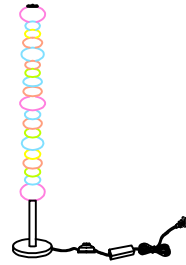

Product style diagram

Steps of installation

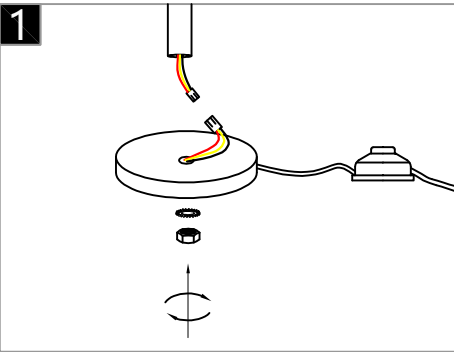

First, connect the wires on the middle column to the wires on the base, and then fix the middle column to the chassis.

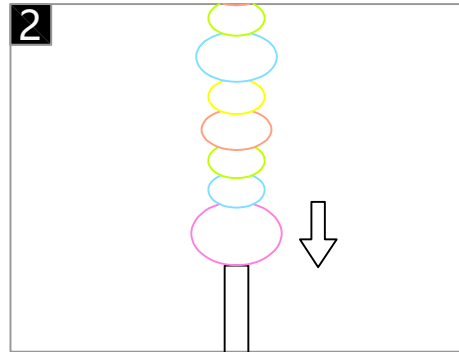

Install the glass cover onto the middle pillar according to the color.

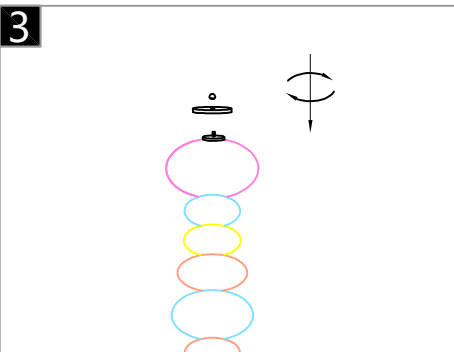

After installing the glass cover, place the lid on the top of the middle pillar and then tighten the nut.

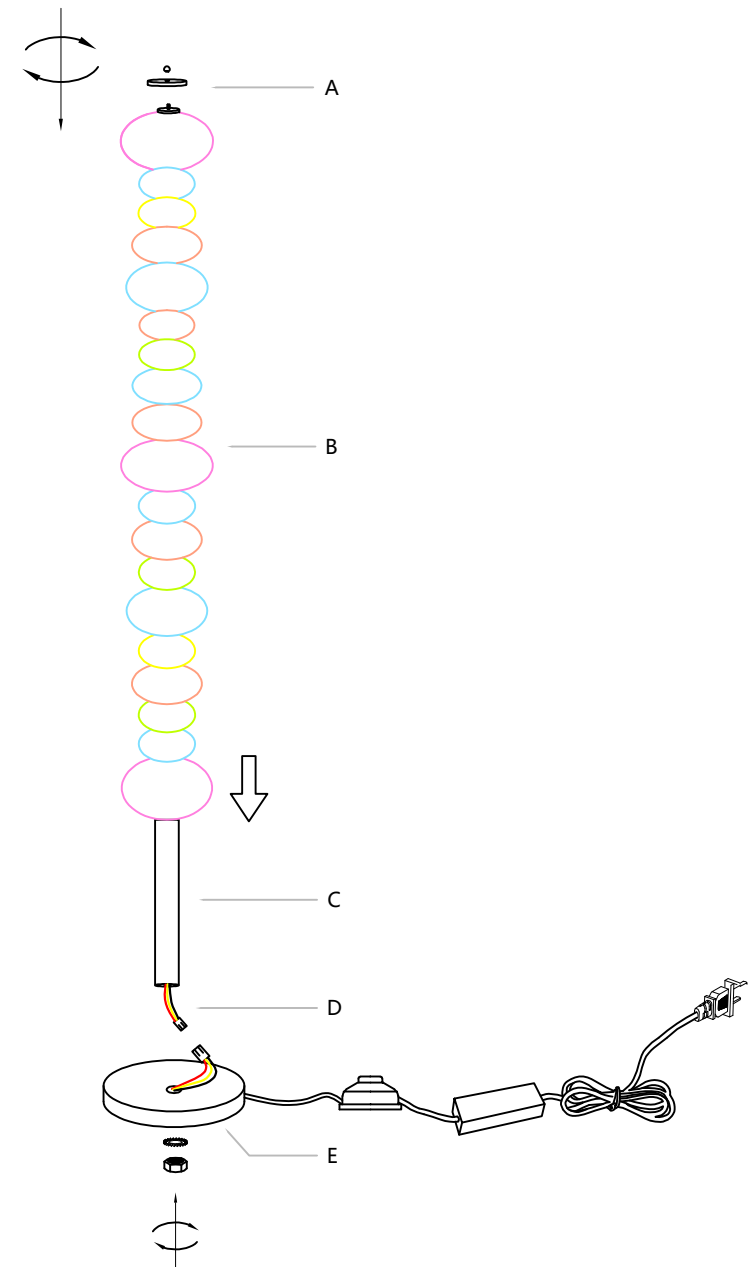

First, connect the wires (D) together. Then, fix the middle column (C) to the chassis (E). Next, place the glass cover (B) on the middle column (C) according to the color and size. After that, put the lid (A) on top of the middle column (C) and tighten the nuts.

Warning:
 This product must be installed by personnel who are familiar with its structure and related hazards, in accordance with the installation specifications. This product is suitable for indoor installation.

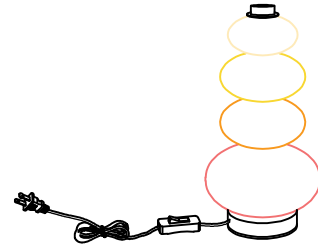

Product style diagram

Steps of installation

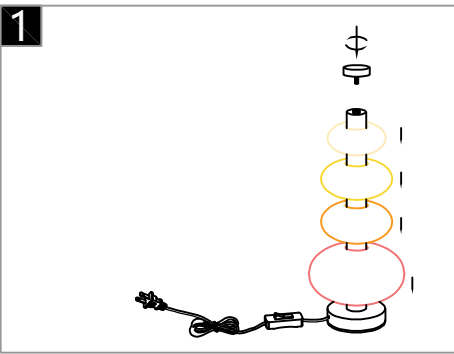

Stack the glass lampshades onto the lamp body in descending order from largest to smallest.

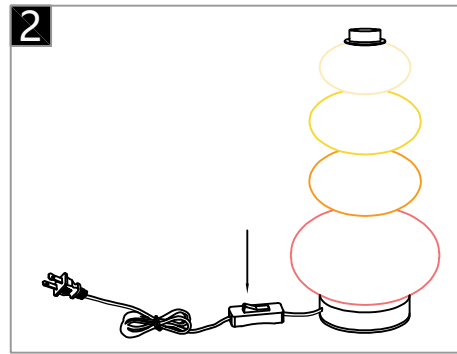

Simply plug the plug into the socket. The handheld switch can control the on/off of the light.

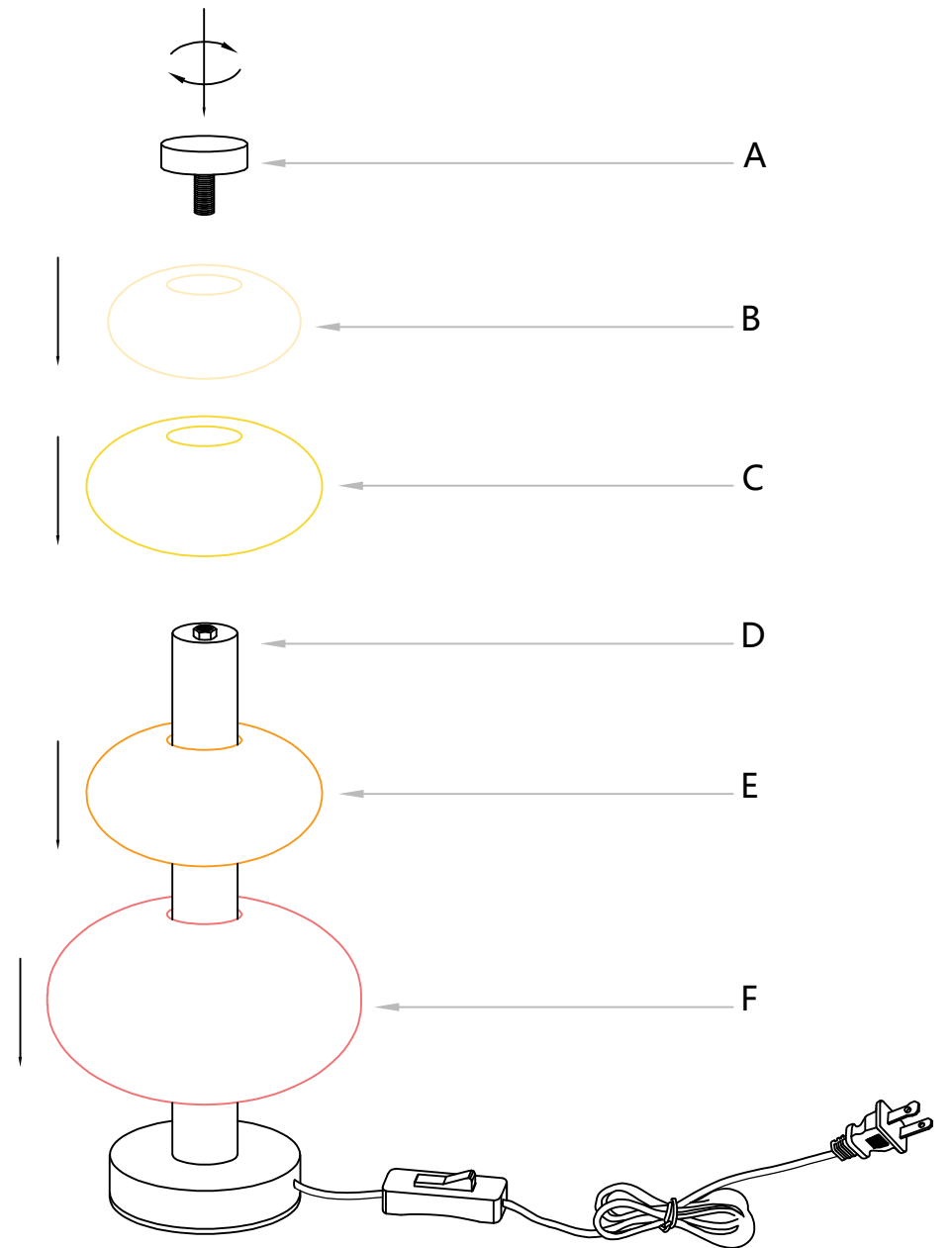

First, stack the glass lampshades (F), (E), (C), and (B) onto the lamp body (D) in descending order from largest to smallest. Next, tighten the top cover (A). Then, simply plug the plug into the socket. The handheld switch can control the on/off of the light.