

# INSTALLATION GUIDE - WM2311

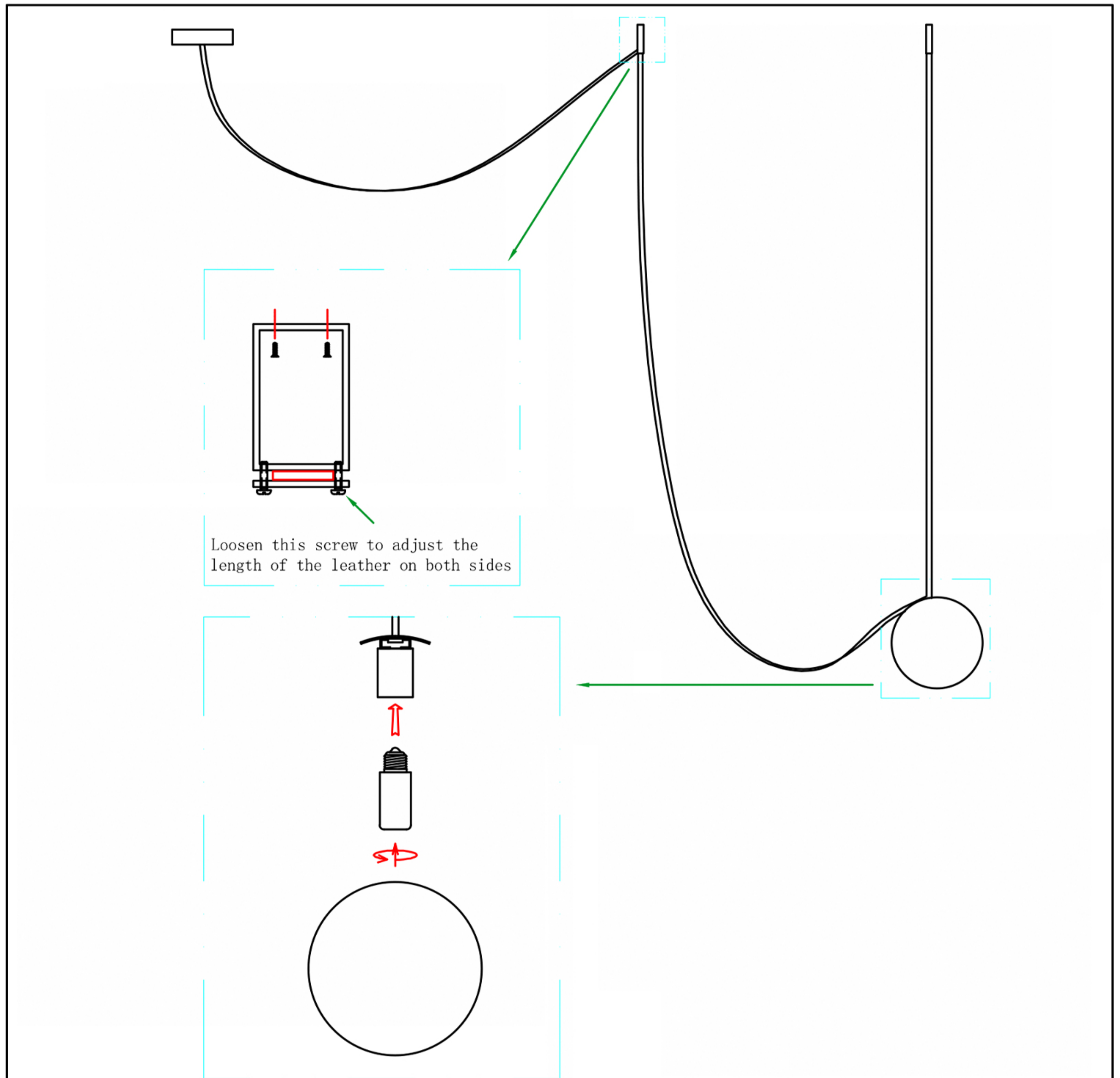

1. Drill the mounting brackets into the ceiling with screws (these come with the light).
2. Use the wire connector to connect the wires of the light to the supply wires according to labels on the wires.
3. Align holes of the canopy with the mounting bracket and secure the canopy with screws.
4. Screw bulbs and globe shades up.
5. Turn the power back on and flip on the light switch to test your light.



# INSTALLATION GUIDE - WM2311

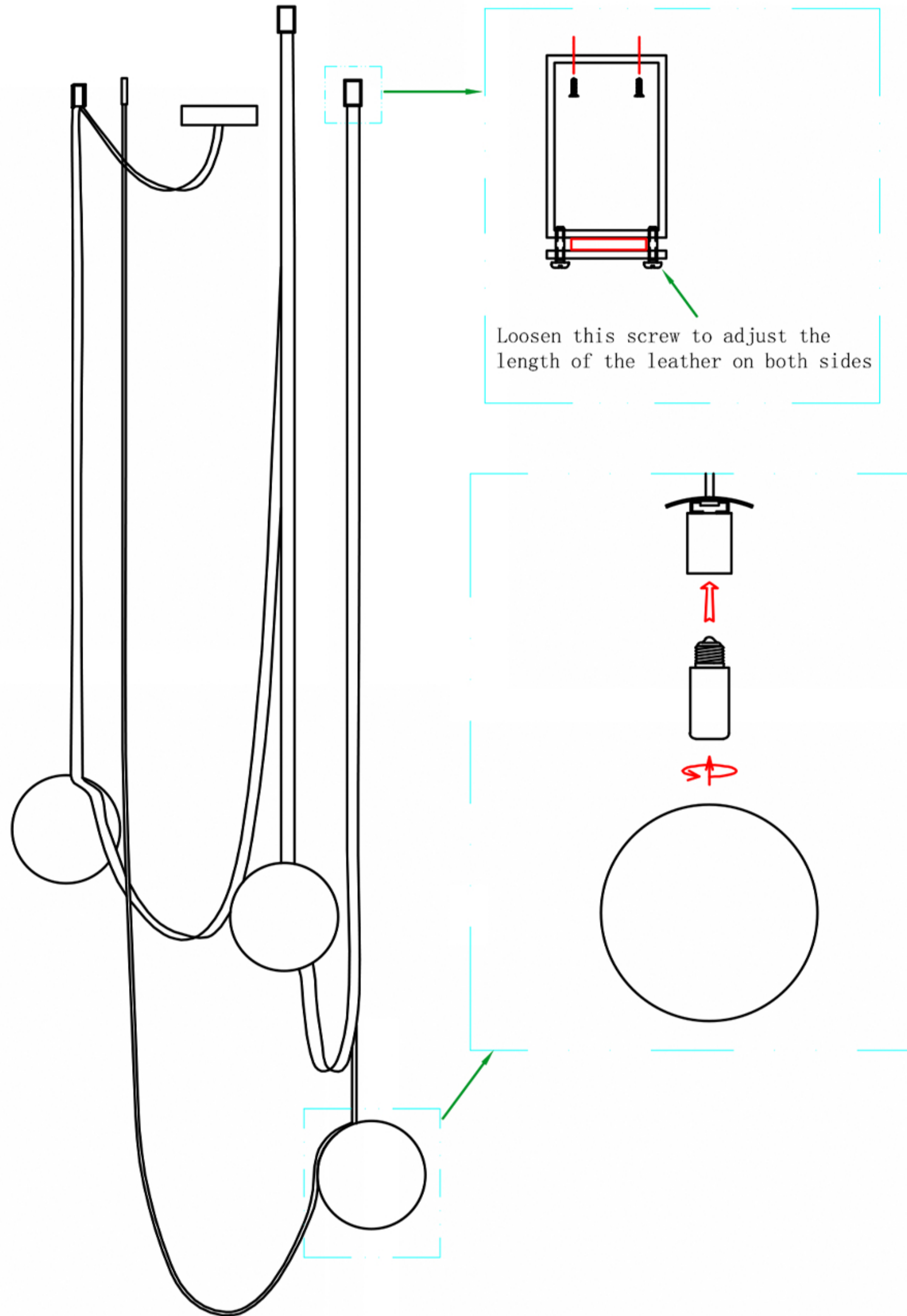

This pendant lamp does not have a fixed hanging method, and leather can be freely shaped. After adjusting the shape, install the light source and twist on the glass lampshade.

1. Drill the mounting brackets into the ceiling with screws (these come with the light).
2. Use the wire connector to connect the wires of the light to the supply wires according to labels on the wires.
3. Align holes of the canopy with the mounting bracket and secure the canopy with screws.
4. Screw bulbs and globe shades up.
5. Turn the power back on and flip on the light switch to test your light.



# INSTALLATION GUIDE - WM2311

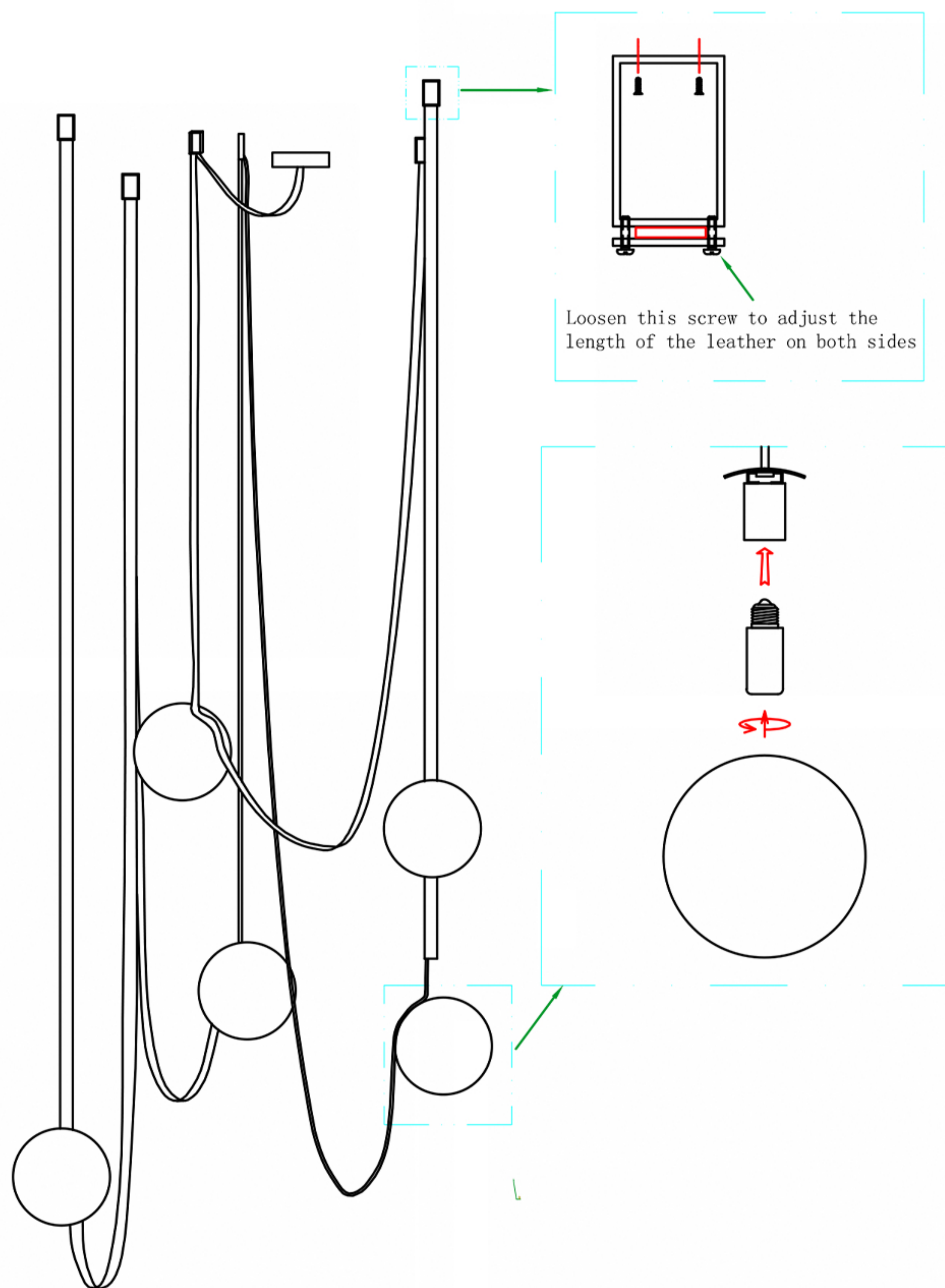

This pendant lamp does not have a fixed hanging method, and leather can be freely shaped. After adjusting the shape, install the light source and twist on the glass lampshade.

1. Drill the mounting brackets into the ceiling with screws (these come with the light).
2. Use the wire connector to connect the wires of the light to the supply wires according to labels on the wires.
3. Align holes of the canopy with the mounting bracket and secure the canopy with screws.
4. Screw bulbs and globe shades up.
5. Turn the power back on and flip on the light switch to test your light.



# INSTALLATION GUIDE - WM2311

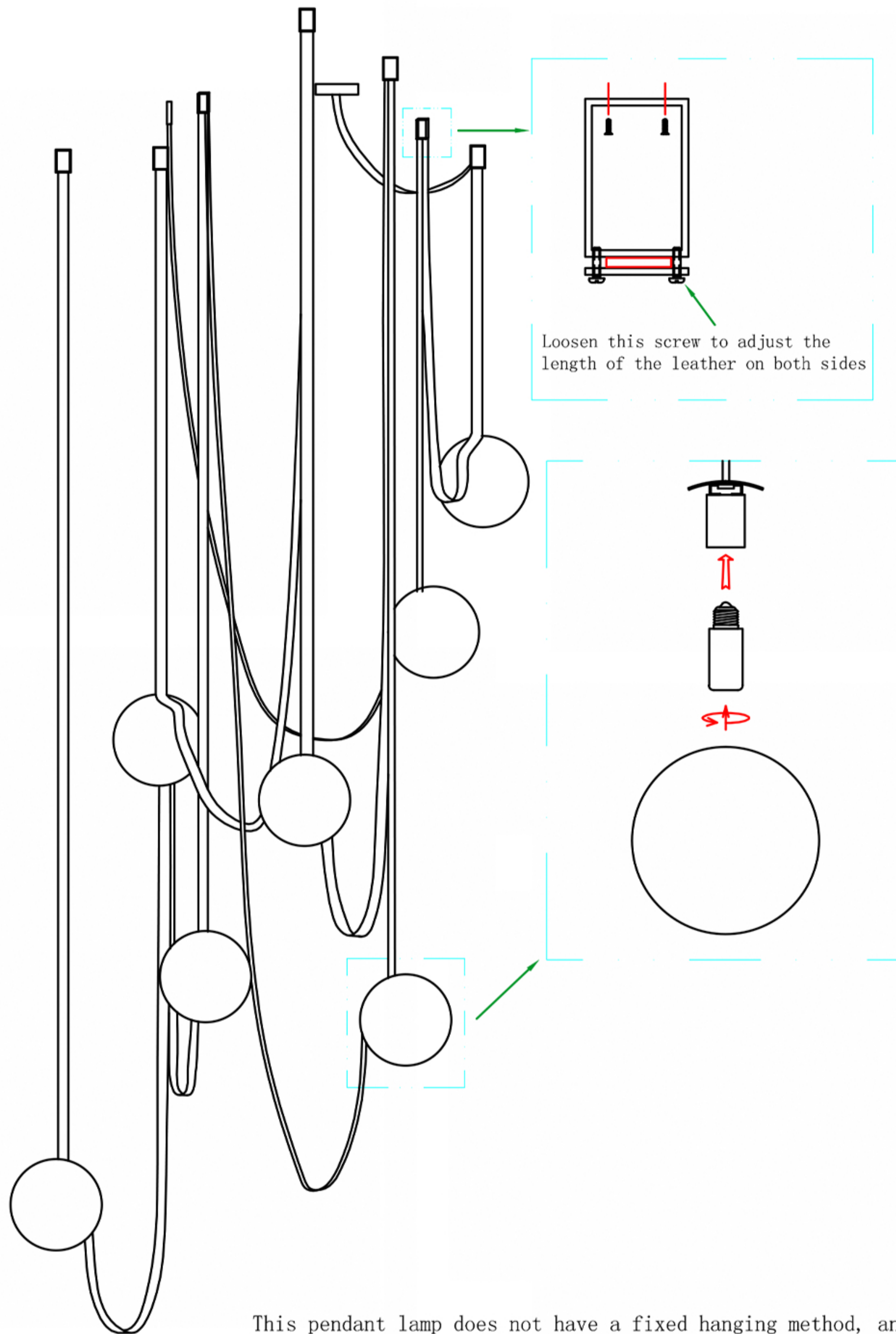

This pendant lamp does not have a fixed hanging method, and leather can be freely shaped. After adjusting the shape, install the light source and twist on the glass lampshade.

1. Drill the mounting brackets into the ceiling with screws (these come with the light).
2. Use the wire connector to connect the wires of the light to the supply wires according to labels on the wires.
3. Align holes of the canopy with the mounting bracket and secure the canopy with screws.
4. Screw bulbs and globe shades up.
5. Turn the power back on and flip on the light switch to test your light.