

# INSTALLATION GUIDE - WM1024

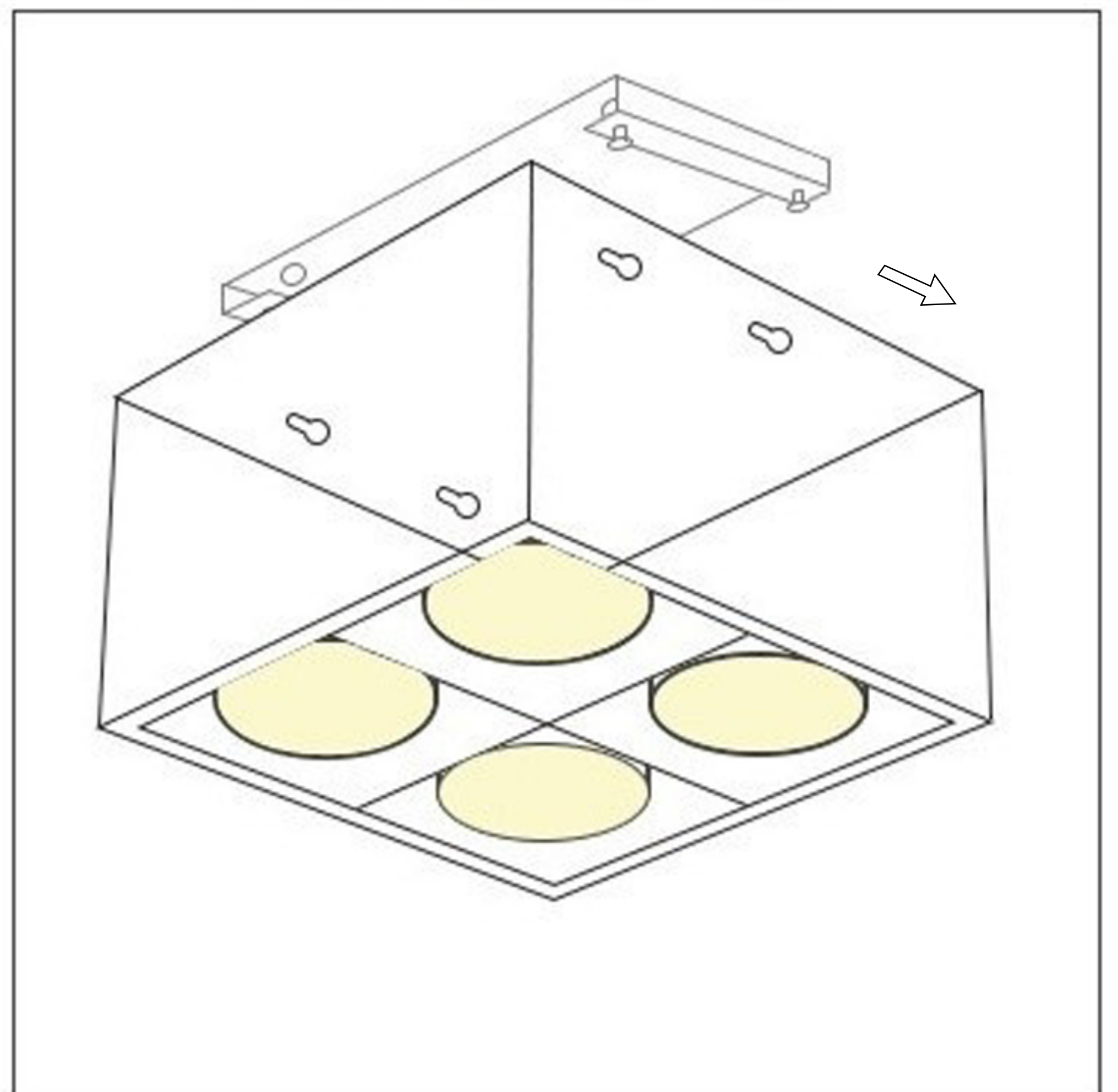
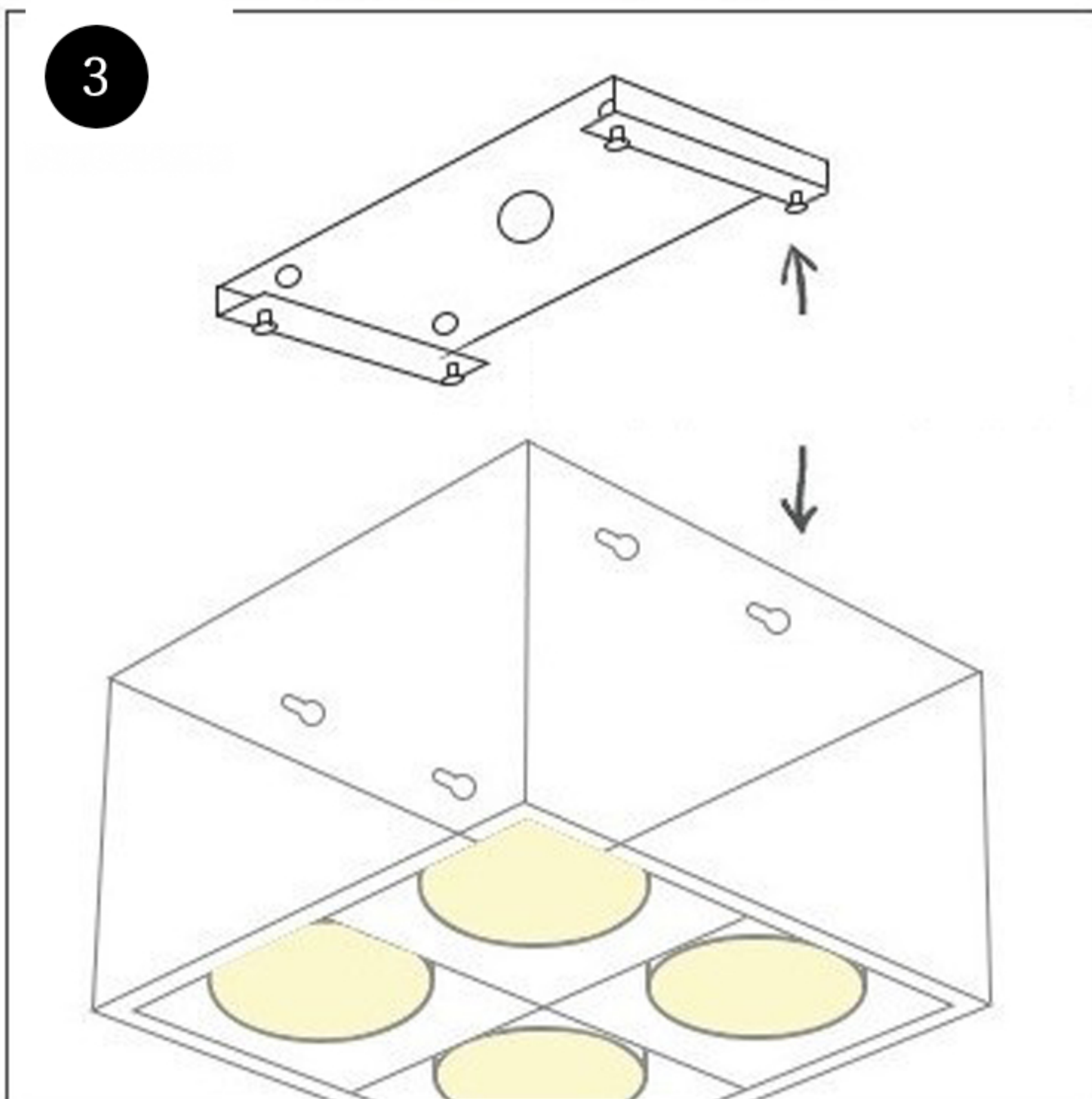
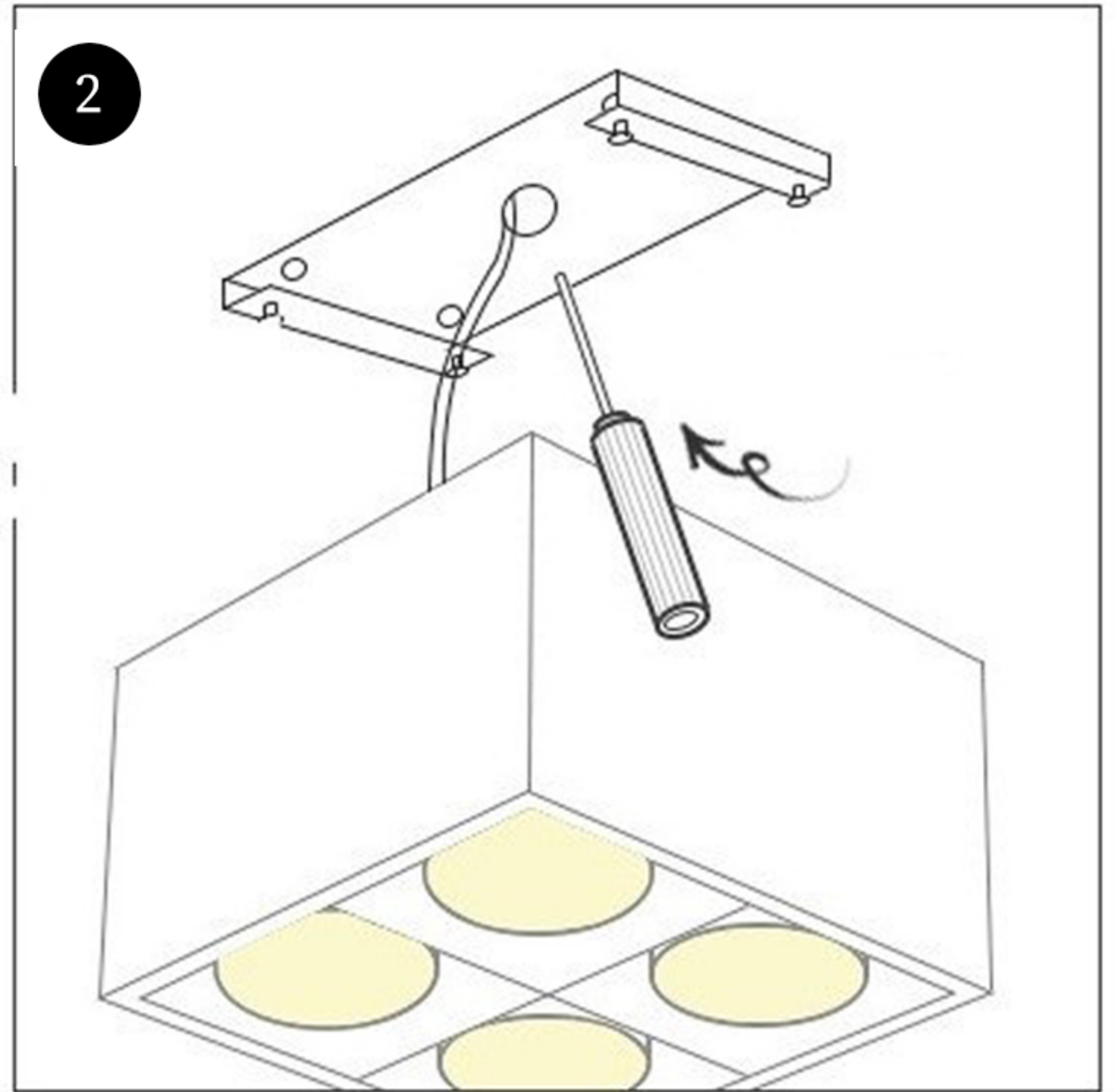
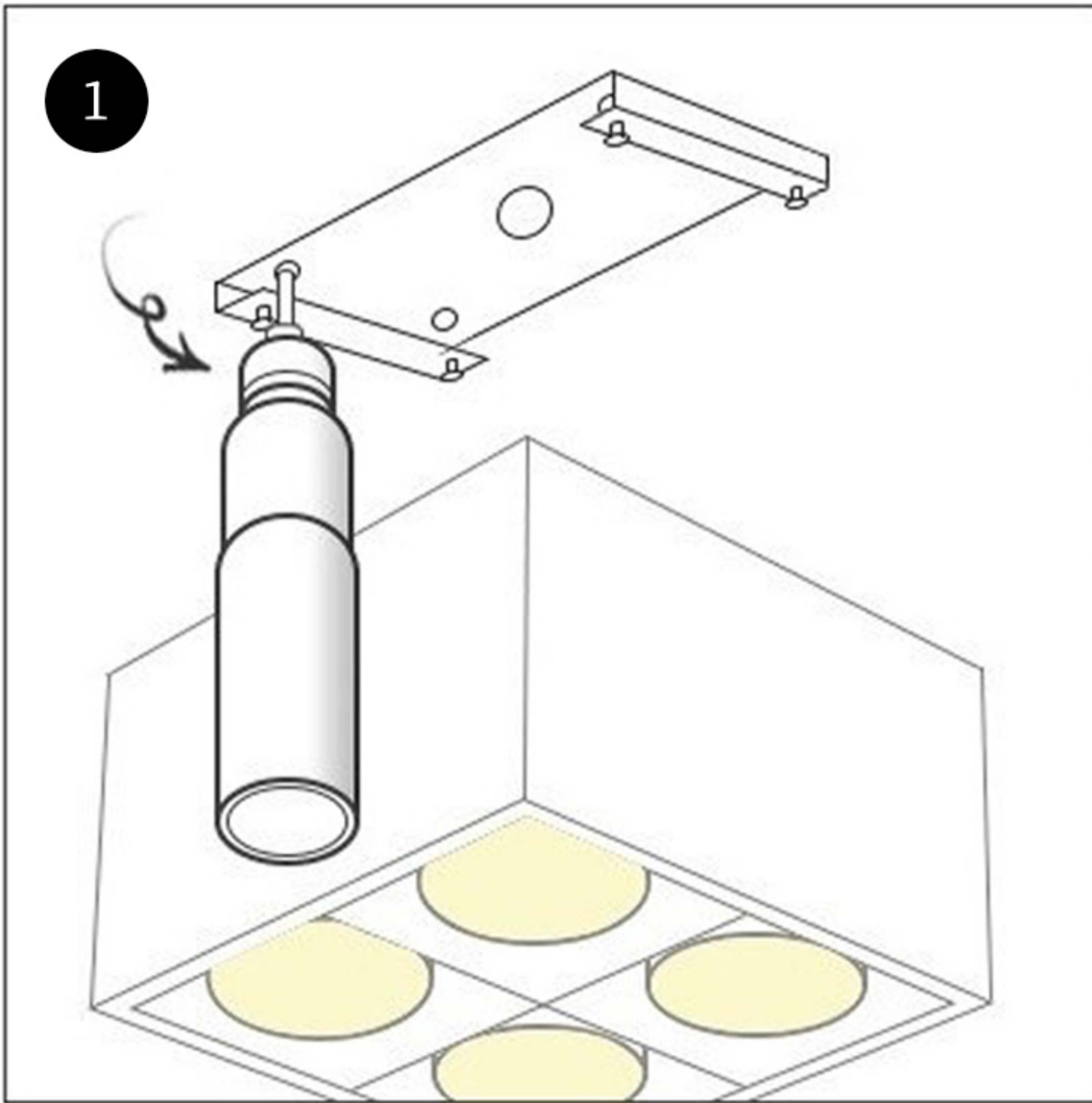

1. Drill the mounting bracket to the ceiling with screws.
2. Use the wire connector to connect the wires of the supply wires according to labels on the wires.
3. Drive the screws into the mounting bracket with keeping the head of the screws downward.
4. Align the holes at the top of lamp body with the screws on the mounting bracket, and push the lamp over to fix it.