

INSTALLATION GUIDE - WM1000

Flower Shape Ceiling Lamp Installation Instructions

Model:TQ-42

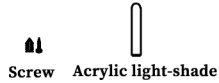
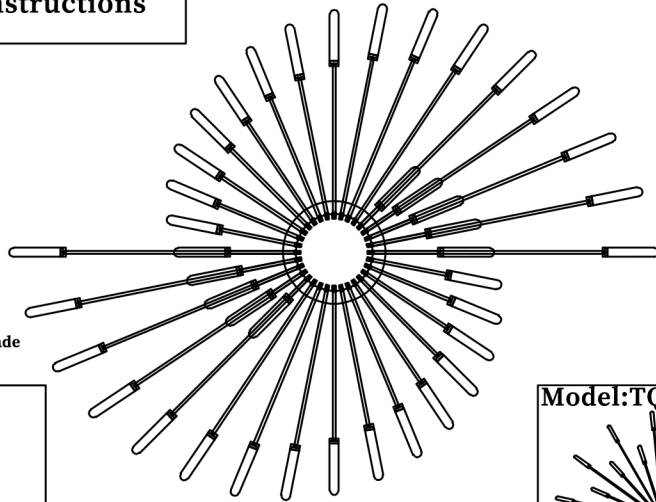

Model:TQ-28

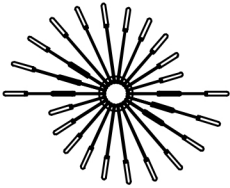

Model:TQ-30

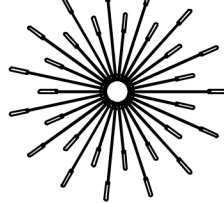

Note: The installation steps of TQ-30 and TQ-28 are the same as the steps of the TQ-42 as seen in the pictures.

Step1: Attach each arm into the canopy with the nuts.

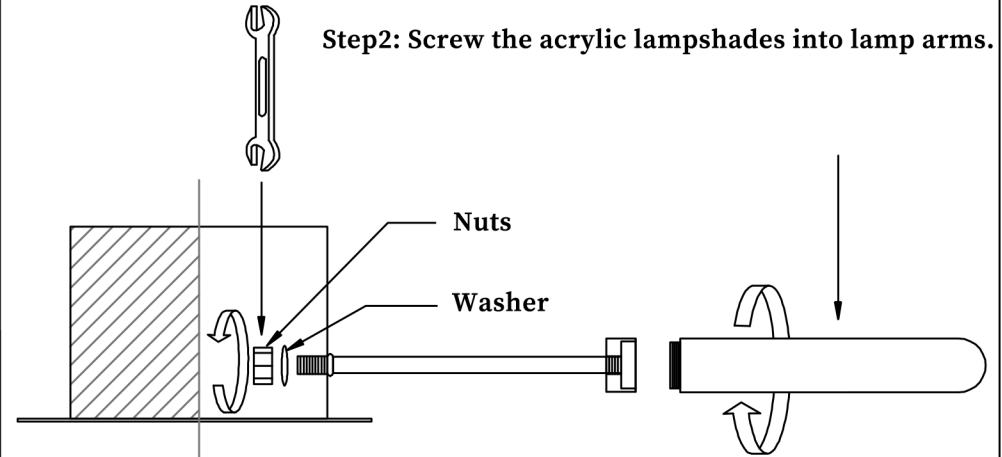

Step2: Screw the acrylic lampshades into lamp arms.

Step3: Fix the hanging plate on the ceiling with the screw and even anchor.

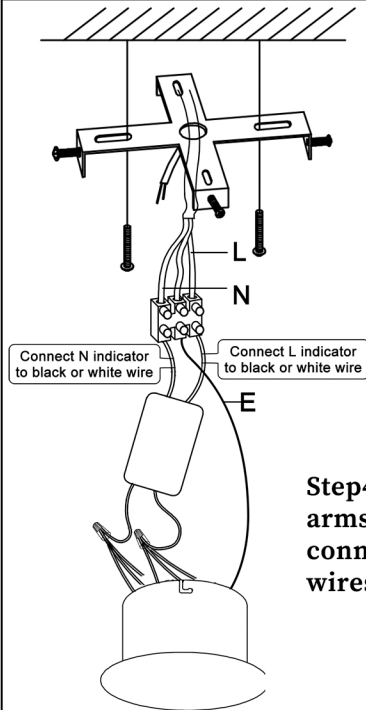

Step4: Use wire cap nuts to connect the wires out of arms to the driver in same colors, and use a wire connector to connect the driver to the reserved supply wires according to tags.

Step5: Drive the screws into the hanging plate and turn the canopy to fix it.

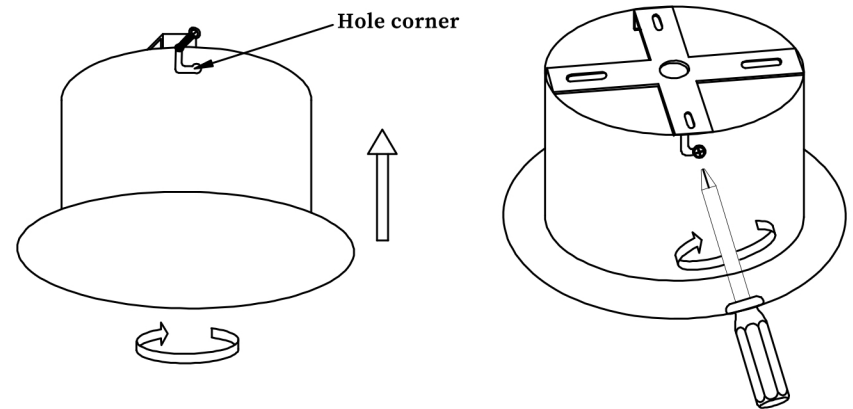

Note: If you have any question about the lamp & the installation, please feel free to contact with us. And you can also see the video of the Installation Instruction in the Product Homepage.