

Warning:

This product must be installed by personnel who are familiar with its structure and related hazards, in accordance with the installation specifications. This product is suitable for indoor installation.

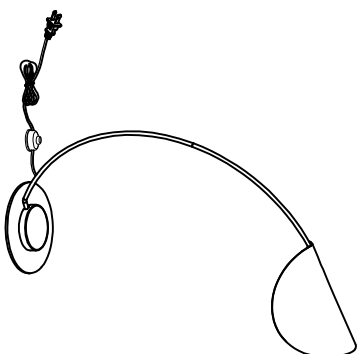

Product style diagram

Steps of installation

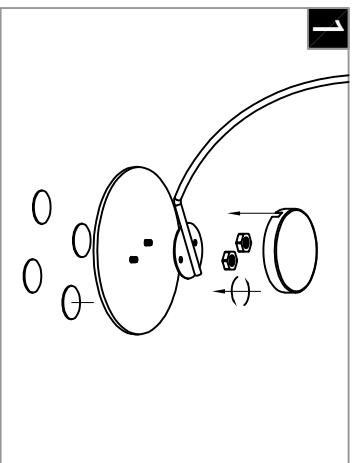

1

First, attach the anti-slip pads to the base. Then, install the lower lamp body with the circular piece on the base and fix it with a nut. Finally, attach the circular cover and magnetize it to stick to the lower lamp body.

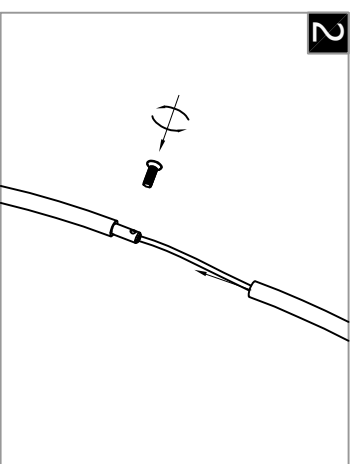

2

Then, install the upper lamp body with the lamp cap on it onto the lower lamp body and secure it in place.

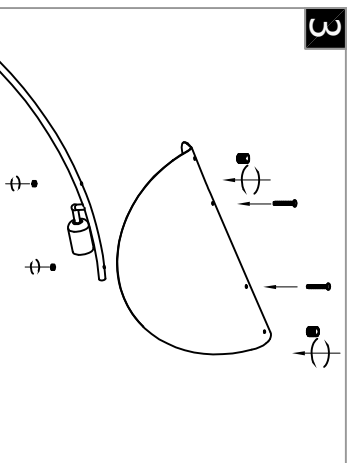

3

Then, fix the V-shaped lampshade onto the upper lamp body using screws.

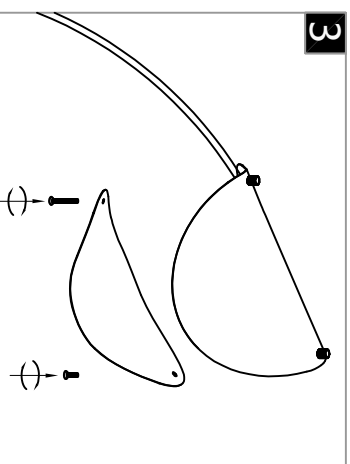

3

Then, fix the lampshade to the V-shaped lampshade using screws, and tighten the nuts.

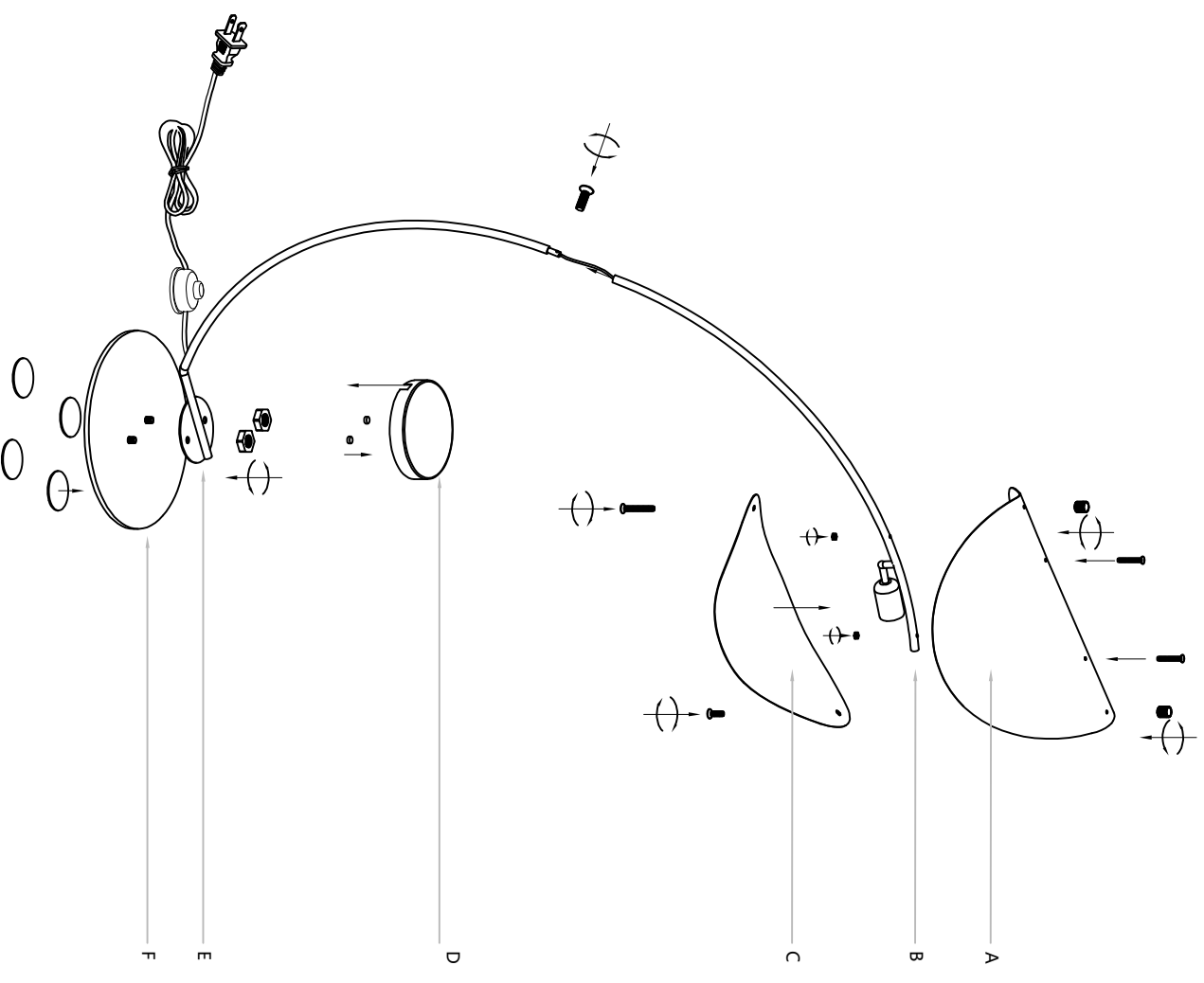

First, attach the anti-slip pads to the base (F). Then, install the lower lamp body (E) with the circular piece onto the base (F) and secure it with a nut. Next, attach the circular cover (D) and magnetize it onto the lower lamp body (E). Then, install the upper lamp body (B) with the lamp head on top of the lower lamp body and secure it. Next, fix the V-shaped lampshade (A) onto the upper lamp body (B) using a screw cap. Then, fix the lampshade (C) to the V-shaped lampshade (A) using screws, and tighten the nuts.