

Warning:

This product must be installed by personnel who are familiar with its structure and related hazards, in accordance with the installation specifications. This product is suitable for indoor installation.

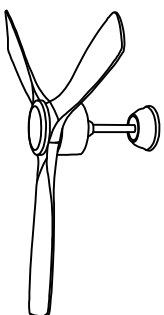

Product style diagram

Steps of installation

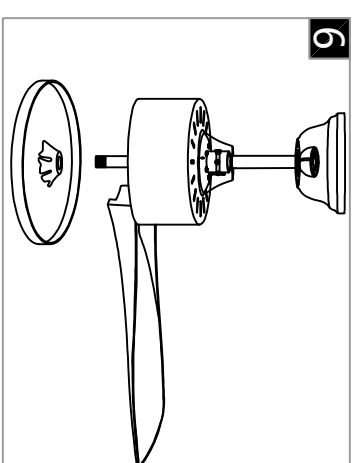
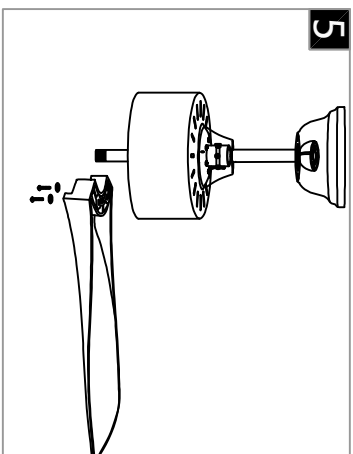
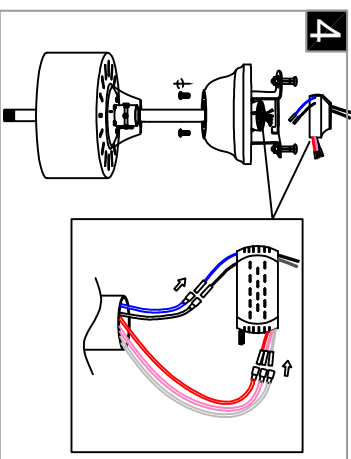
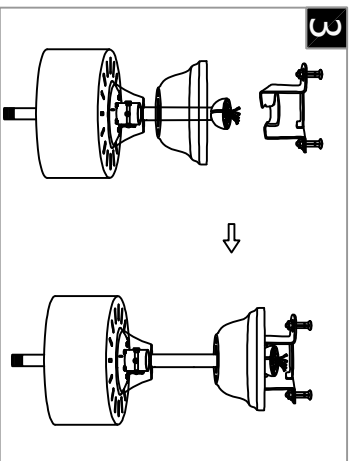
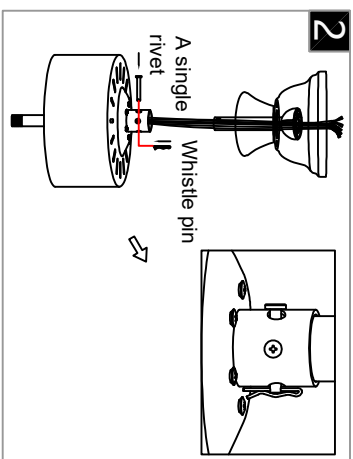
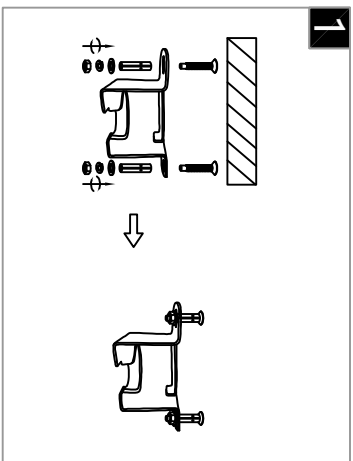

Install the fan blades onto the motor using screws and washers

Turn the fan baffle onto the threaded rod of the motor.

Note: The ceiling must be able to bear a weight of 20 IBS. Then, follow the steps below to fix the mounting plate onto the ceiling.

Insert the wires on the motor from the connecting rod into the driver by color, then press the entire lamp body onto the motor, insert the iron pin, and tighten the screw.

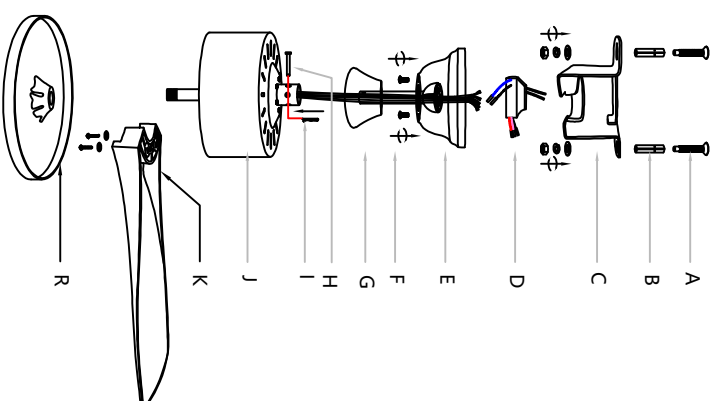

Attach the fan blades (K) to the motor (D) using screws and washers, then screw the fan cover (R) onto the threaded rod of the motor (J). Next, use the connecting rod (F) to align the opening of the motor (D) with the bottom cover (G) downward. Then, pass the wires through the bottom cover (G) and the connecting rod (F) and insert them into the top cover (E). Then, align the holes of the motor (D) opening with those of the connecting rod (F) using the pin (H), insert it in, and then insert the pin (I) into the iron nail (H). Then cover the screw (A) with the iron nail (H), screw it into the ceiling, and align the screw (B) with the hole (C) on the mounting plate (C) using the nut and washer. Finally, use the head of the lamp body connecting rod (F) to suspend the lamp body onto the mounting plate (C), and connect the wires on the lamp body to the power driver (D). According to the color, connect the neutral wire and the live wire above the power driver (D) to the wires above the ceiling. It is best to align the holes at the bottom of the top cover (E) with the holes on the mounting plate (C), and then tighten the screws.

Insert the connection rods of the lamp body into the suspension bracket one by one, then put the power driver into the top cover, and insert the reserved driving wire into the connection rods.

Insert the connection rods of the lamp body into the mounting plate one by one, then put the power driver into the top cover, and insert the reserved driving wire into the connection rods.

① ALLOFF	⑥ Natural Wind Mode
② Forward	⑦ Reverse
③ FAN Speed control gears 1-6	⑧ FAN/OFF
④ FAN 1-hour Timer	⑨ FAN 4-hour Timer
⑤ LIGHT ON/OFF	⑩ FAN 2-hour Timer