

Warning:

This product must be installed by personnel who are familiar with its structure and related hazards, in accordance with the installation specifications. This product is suitable for indoor installation.

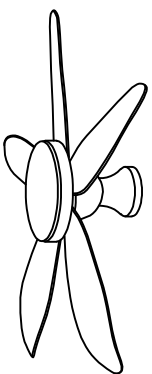

Product style diagram

Steps of installation

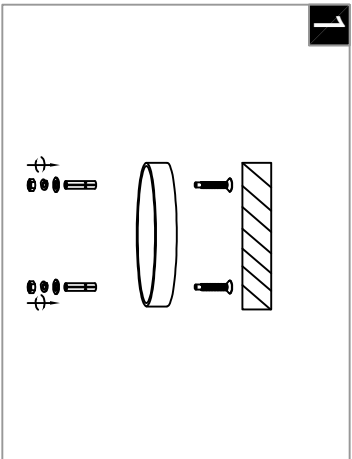

1

Note: The ceiling must be able to bear a weight of 20 IBS. Then, follow the steps below to fix the mounting plate onto the ceiling.

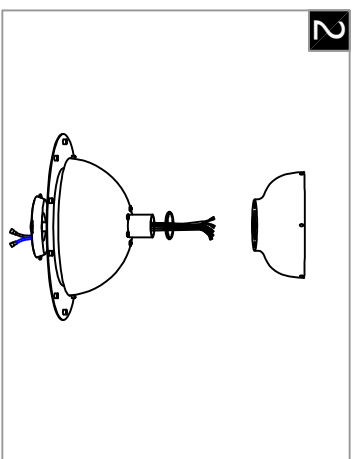

2

Remove the screws from the motor, then add washers to the motor shaft, then align and connect them, and secure the top cover with the removed screws.

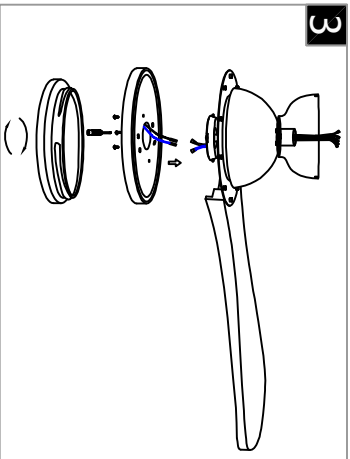

3

Connect the wires on the light source cover to the wires on the motor by color, align the screw holes on the motor with the light source cover, and then fix the screws with a screwdriver. Then twist the acrylic lampshade clockwise over the light source lampshade.

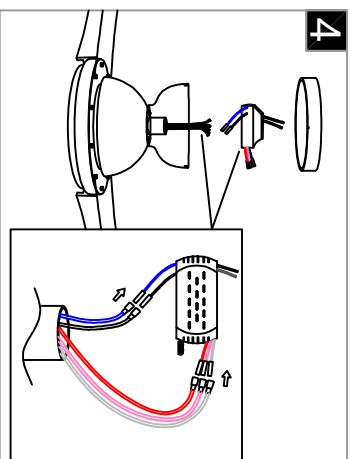

4

Then connect the drive power supply and the motor reserve line together, and then connect it to the reserve line on the ceiling and to the terminal block. Finally, fix the overall top cover position onto the installation plate.

Install the fan blades (H) onto the motor (G) using screws and washers, then insert the wires according to their colors into the motor (G) above the light source cover (I), then align the holes on the light source cover (I) with the holes on the motor (G), lock the screws, and then rotate the light source cover (J) clockwise until it aligns with the light source cover (I). Then place the rubber washer (F) on the rod of the motor (G) and install it onto the top cover (E), then connect the reserved wire and the driving power supply (D), then connect the reserved wire on the driving power supply (D) and the reserved wire on the mounting plate to the terminal (C), then use a nail to insert a metal pin into the ceiling, then use the mounting plate (B) to align the screws (A), then use a nut and washer to lock it, and finally align the position of the light source cover (E) of the lamp body onto the mounting plate (B), and then tighten the screws on the sides.

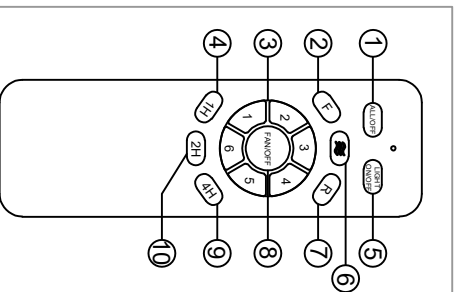
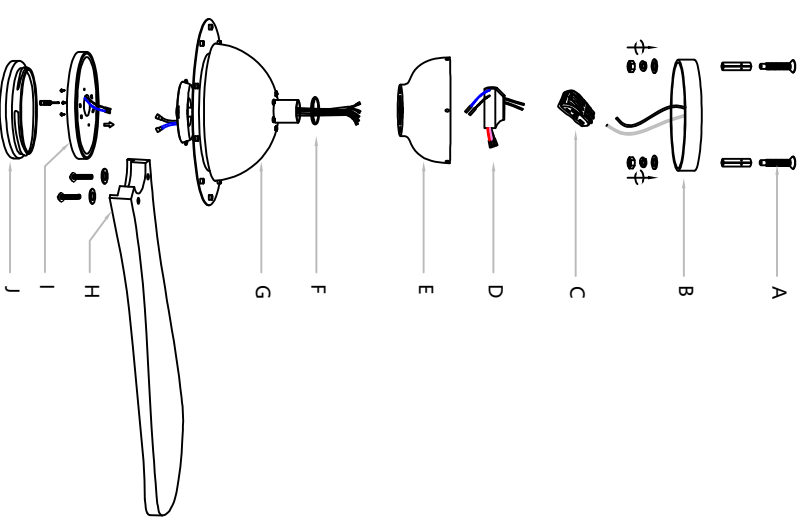

- ① ALLOFF
- ② Forward
- ③ FAN Speed control gears 1-6
- ④ FAN 1-hour Timer
- ⑤ LIGHT ON/OFF
- ⑥ Natural Wind Mode
- ⑦ Reverse
- ⑧ FAN/OFF
- ⑨ FAN 4-hour Timer
- ⑩ FAN 2-hour Timer