

**Warning:**

This product must be installed by personnel who are familiar with its structure and related hazards, in accordance with the installation specifications. This product is suitable for indoor installation.

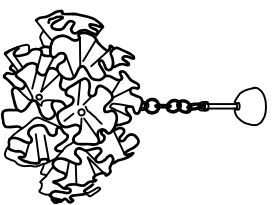

Product style diagram

**Steps of installation**

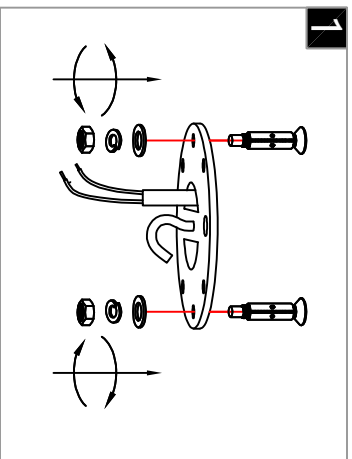

Fix the mounting bracket to the ceiling.

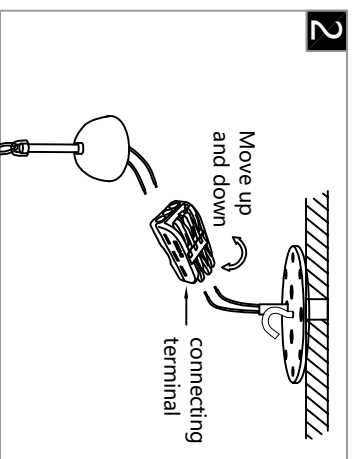

Use the quick connector to connect the wires to the wires on the ceiling.

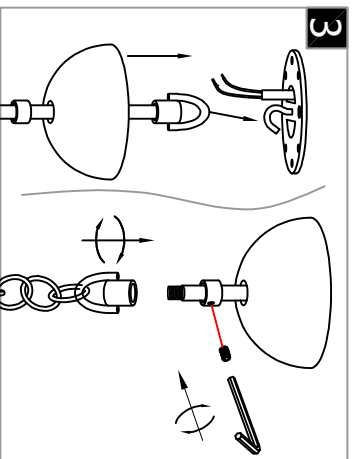

Install the pulley at the position of the lamp body wires, then pass the wires through the pulley nut, the clamp, the cover, and the round tube, and install the pulley nut onto the round tube. Install the round tube onto the hook of the mounting plate, Cover the mounting plate with the top cover, and lock the screws on the clamp.

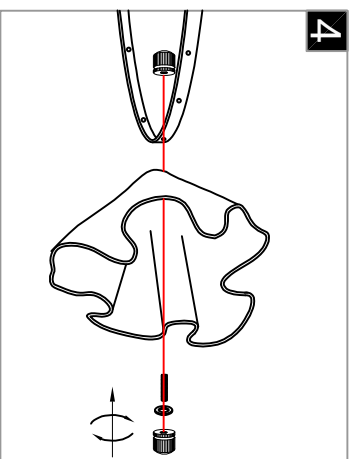

Install the bulb onto the lamp body, combine the nut with the threaded rod, pass it through the hole in the lamp body, then through the glass lampshade, put on the rubber ring, and tighten the nut.

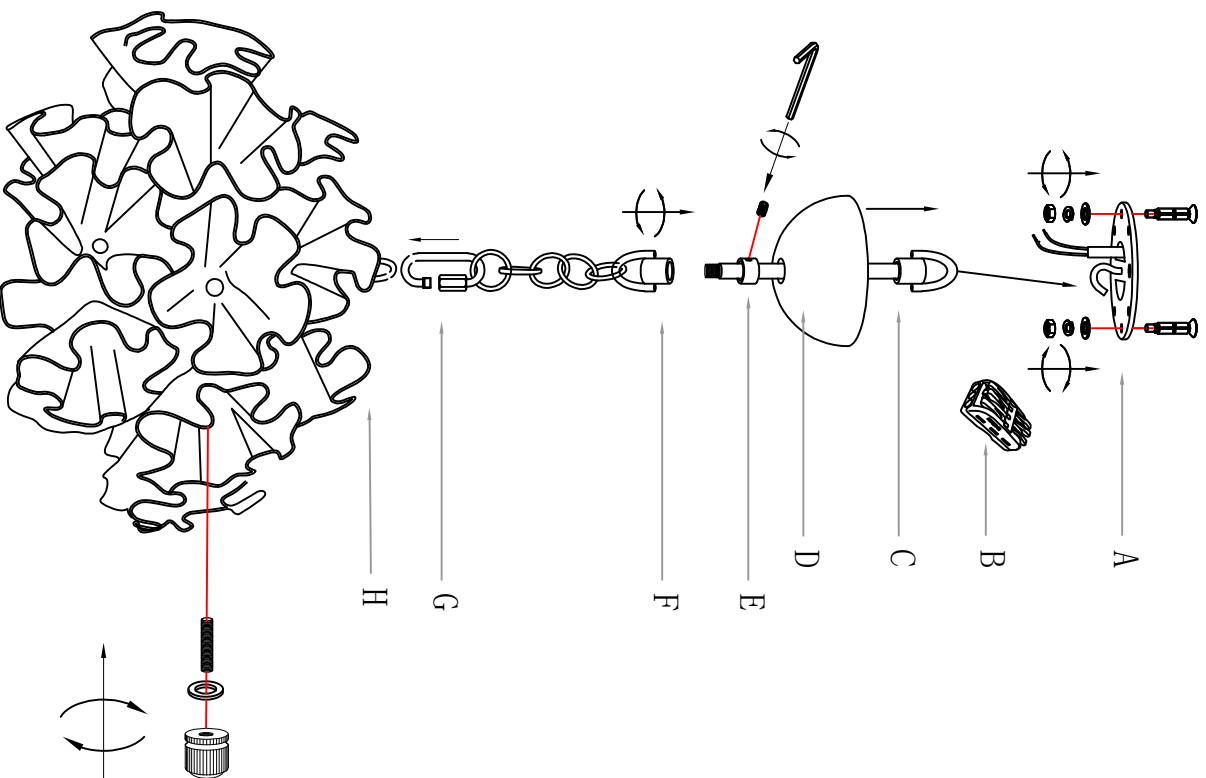

First, fix the mounting bracket (A) to the ceiling.

Next, install the pulley (G) at the position of the lamp body wires, then pass the wires through the pulley nut (F), the clamp (E), the cover (D), and the round tube (C), and install the pulley nut (F) onto the round tube (C).

Then, install the round tube (C) onto the hook of the mounting plate (A), and use the quick connector (B) to connect the wires to the wires on the ceiling. Cover the mounting plate (A) with the top cover (D), and lock the screws on the clamp (E).

Then, install the bulb onto the lamp body, combine the nut with the threaded rod, pass it through the hole in the lamp body, then through the glass lampshade (H), put on the rubber ring, and tighten the nut.